



Installation Guide



WARNING

Tighten clamps securely on side rails before driving vehicle, to prevent cover from blowing off.

Tri-fold Soft Tonneau Cover

Parts List:	Assembled Tri-fold Cover	1pc
	Locking pin	4pcs or 2pcs(for truck with factory Utility Track System)

Step 1

Place assembled cover over cab end of truck box



Step 2

Unfold the cover fully and adjust position over the truck bed for proper alignment on cab/tail.



Step 3

Carefully refold the cover without shifting its position on the truck bed.

Step 4

Adjust the clamping bolt to proper position. 1) Insert bolt in proper hole. 2) Move the bolt base to secure position.

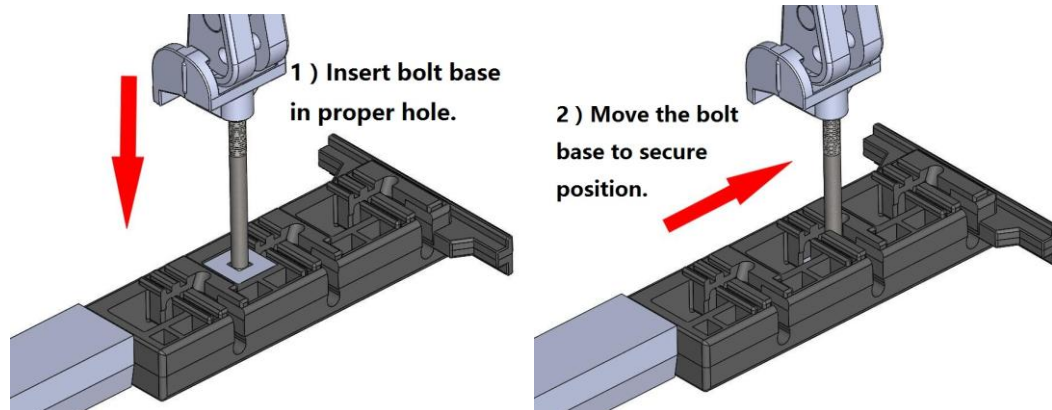

Step 5

Secure the Front Clamps (left and right) by pulling the clamp handle down to clamp the metal bed wall edge of truck. Note: If necessary, adjust the clamp position by rotating the clamp on the bolt to ensure the clamp is tightly clamped on the metal bed wall edge of truck. Do not secure to only lip of bedliner or rail cap.



Step 6

Insert locking pins into front clamps

Step 7

Secure front safety strap (read attached "Safety Strap Instructions")

Note. This Step is only for trucks without Utility Track channel.

Step 8

With truck tailgate open and front clamps secured, completely unfold the cover. Repeat Step 5 and 6 on the two rear clamps.

For Nissan/Toyota Trucks (with Utility Track channel) only

**Slide the retainer plates into the side channels on the vehicle bed. (2 per side, 1 goes in front and 1 in back)*



**Attach the clamp bracket to the plate with the included allen head bolts.*



**Line the bracket up with the tri-fold cover clamp location once they are lined up. Secure bracket to the vehicle bed rail.*



**Secure Tri-fold Cover latches to these brackets*

To open the cover:

Release the rear clamps, fold the cover forward.

Note 1): when folding the cover, make sure to secure the rear clamps into the cross bar.



2): When cover is folded completely, secure the folded cover by fastening the straps with buckles together. Pull the straps to tighten the folded cover tightly.



Attention:

Never Drive with a cover in partially opened position. When driving, cover must be secured with 4 clamps or completely folded up and secured by front clamps and buckles.